



## Shower Walls and Wet Areas

The wedi Building Panels can be applied to shower walls and wet areas perpendicular or parallel to the framing, saving time and reducing joint frequency. The panels are fastened quickly and easily in place using wedi fasteners. Once the panels are secured and seams and fasteners are sealed with wedi Joint Sealant, tiling can begin immediately. All in a fraction of the time previously required by traditional methods. The wedi Building Panel combines tile backer board and waterproofing in one product and installation step. This saves time and cost. Its solid waterproof core eliminates concerns typically associated with alternative waterproofing products such as pinholes or delamination. The entire shower structure is protected by wedi's warranty: from top to bottom! The wedi Building Panel is successfully tested under ANSI 118.10 test standard for loadbearing, bonded, waterproof membranes as well as ASTM C578 the standard for cementitious coated foam backer board.

## General Limitations/Requirements (installation on walls and ceilings)

- 1/2" (12.7 mm), 5/8" (15.9 mm) or 1" (25.4 mm) Building Panels are the recommended minimum thicknesses for installation to framing
- Wood Framing: 2 x 4's (framing depth 3 1/2" [89 mm]), Maximum stud spacing 16" (406.4 mm) o.c.
- Metal framing requirement 20 gauge or heavier studs with maximum 16" (406.4 mm) o.c. spacing
- Maximum allowed deflection L/360 based on gauge, stud material, design and connection points of framing, and consideration of total load.
- wedi 1" (25.4 mm) Building Panel or thicker can be used over 19.1" (485 mm) o.c. spaced wall framing
- 2" (50.8 mm) wedi alkali resistant fiberglass mesh tape to be applied over all seams in dry areas. wedi waterproof Joint Sealant or wedi Sealing Tape to be applied over all seams and fastener locations/heads if a waterproof installation is required
- Attach wedi Building Panels with one fastener per every 12" (304.8 mm) and in between adjacent panels (seams) over wall framing
- On ceilings, use one fastener per every 6" (152.4 mm) and in between adjacent panels (seams)
- wedi Waterproof Joint Sealant or wedi Sealing Tape to be applied over all seams and fastener heads if a waterproof installation is required
- wedi Joint Sealant or wedi Subliner Sealing Collars are used where plumbing or other equipment protrusions through walls must be sealed
- The Building Panel should be notched out at the bottom to install safely and plumb against the flange of the tub. A bead of wedi Joint Sealant is applied against the flange of a tub. Use wedi Tub sealing tape with its butyl sealing strip to create such connections with non-nailing flange tubs or trays.
- wedi Product Systems are only used for interior installations.
- wedi Building Panel is not a sound deadening product. While it may reduce airborne sound, it is not IIC or STC rated and should not be used to actively reduce or remove sound transmission.
- Do not use as a wear surface or without tile/stone or other suitable coverings.
- wedi products are tested and classified with an A rating for fire behavior safety but are not a fire resisting barrier. An alternative backing providing actual fire resistance must be installed (e.g. 90 minute fire rated drywall)
- Do not use organic mastic adhesives for setting tile on wedi Systems in wet areas.
- Adhesive coverage under tile or other suitable surface finishes in wet area installations must be a minimum of 95%.
- In steam showers or steam rooms use only setting materials specifically recommended by the manufacturer for this application, and submerged and hot temperature areas. Setting materials recommended by wedi are commonly solid epoxies (meet or exceed ANSI 118.3) or high performance modified mortars (meet or exceed ANSI 118.15). Test the adhesion over vapor barriers.
- Use only thinset mortar setting materials suitable for installation and adhesion to the specific substrate types.
- Ensure tile and setting materials incl. grout are suitable for the application (e.g. submerged applications or steam rooms)
- Certain substrates must be primed prior to thinset mortar attachment.
- Do not use where substrate is subject to excessive moisture and moisture content changes.
- A wedi installation does not replace the need for Expansion and/or Movement joint placement within a tile installation. Please follow recommendations found in the TCNA guidelines (Detail EJ171).
- All installations shall be in conformance with IRC for residential installations and IBC for commercial installations or applicable building codes in a region including the consideration of properly designed substrates. All installations including the consideration of properly designed substrates should be in compliance with current TCNA Handbook for Ceramic, Glass and Stone Tile Installation, use details specific to "Cementitious Coated Extruded Foam Backer Board". wedi's technical recommendations supersede all requirements of IRC, IBC, IPC or TCNA where in conflict and exceeding minimum requirements established by the above mentioned institutions.
- Contact wedi for installation of tile or stone smaller than 2 x 2" (50.8 x 50.8 mm) and larger than 12 x 12" (304.8 x 304.8 mm) over wedi product, and where wedi Building Panel is used in commercial use areas, to learn more about the best practices and requirements applied in such applications. Follow tile manufacturers' recommendations for appropriate tile choice, setting materials and installation techniques.
- When building free standing, non framework attached walls using wedi 2" (50.8 mm) building panel, the maximum wall length may extend to 4 ft. (1,220 mm) without the need to firmly attach the wall to the ceiling (attachment to floor and wall only). It is helpful to double up walls for larger adhesion and support surfaces to floor and wall, and to Z-notch connect these walls to channels of wedi Shower Bases. Such structures will produce blue foam edges which should be covered with wedi 1/8" (3.2 mm) or thicker panels to provide best adhesion surfaces for tiling. Such panel strips can be installed with wedi Joint Sealant.
- Maximum weight of surface coverings and setting materials applied to wedi Building Panel on walls are 23 lbs/sqft. (112 kg/ m<sup>2</sup>) and 18 lbs/sft (88 kg/ m<sup>2</sup>) on ceilings.
- All wall substrates are to be prepared prior to installation to guarantee plumb, even, level and squared (corner) areas to install wedi product. On ceilings, the substrates must be even, level and squared with the wall.





## Framed Walls

Whether in wet or dry areas, wedi Building Panels install perfectly well over wood or metal framed wall construction. The wedi Building Panels combine lightweight properties with a flexible strength and the right and proportionate stiffness of a real tile backer board. When tile is installed, the wedi Building Panel does not push in easily. After the installation, it will not succumb under any ordinary tile or stone weight. This is a fact which not only considers the building panel, but also our fastening and joint treatment methodology. As a system, wedi Building Panel installations over framed walls are unique in their ability to resist shear and tensile forces when benchmarked to any other directly competitive product or copy. In keeping true to wedi quality level requirements, wedi Building Panels meet and exceed all relevant industry standards including the demanding shear bond strength requirements under ANSI 118.10 Section 5. With wedi, you not only use a high performance backer board but a solution based product. Even wedi's fastening hardware including heavy gauge washers and ceramic coated screws contribute to a system approach with no weak links.

## Installation over Framed Walls

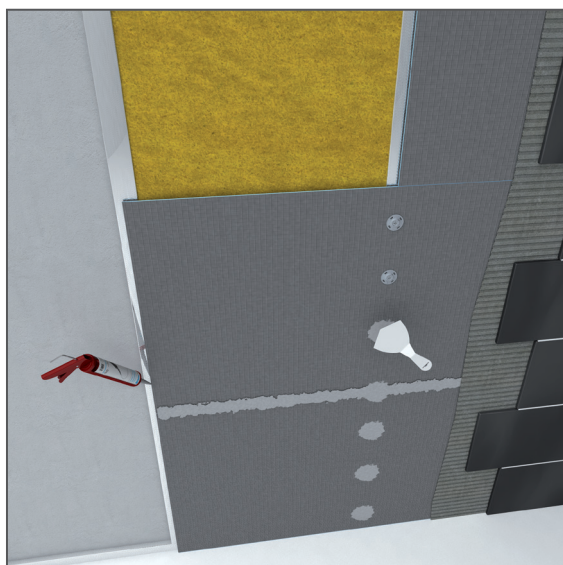

Using only a utility knife, wedi Building Panels are effortlessly cut and shaped.

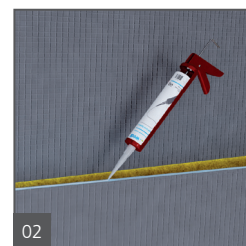

A continuous 1/2" (12.7 mm) bead of wedi Joint Sealant is applied on the foam edges of a wedi Building Panel before another panel is joined by butting tightly.



Apply 1 wedi fastener per every 12" (304.8 mm), with an extra fastener applied directly in the seam to provide a flush transition between panels. On a ceiling, apply 1 wedi fastener per every 6" (152.4 mm). The washer heads are dimpled below the surface of the wedi Building Panel so a flat surface is maintained.

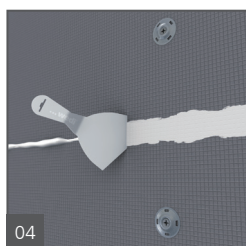

All excess wedi sealant is spread flat over all joints using a putty knife. Where needed, an extra bead of sealant is applied on top of the joints and spread flat. The joints should be covered a full 1" (25.4 mm) on both sides of the seam. Especially wedi Joint Sealant provides little build-up making for square and tight corner areas perfect for tiling. All fastener locations are waterproofed using wedi Joint Sealant spread flat and widely over each washer.



Alternatively, wedi sealing tape can be used instead of the wedi Joint Sealant and applied in modified thinset. The sealing tape provides adequate splash water protection but should not be used in areas with constant wetness/ water exposure, because thinset mortar might allow pressing water to migrate underneath the sealing tape through the thinset mortar. If you use wedi Building Panels with wedi Shower Bases, wedi Joint Sealant must be used in-between seams and on top of seams. No sealing tape is required in these applications. Please consider: sealing tape is installed in cement based thinset and can allow pressing water to migrate under the tape. The thinset holding the tape can also not provide protection against movement. Both challenges are addressed more efficiently by using wedi Joint Sealant. In dry areas, the seams can be treated with an alkali resistant fiberglass mesh tape by wedi.

Where wedi Building Panel transitions to drywall panels, wedi reinforcing tape, or sealing tape or wedi Joint Sealant may be used. The drywall surface should be primed. Conversely, if mesh and gypsum plaster is used over such seams in dry areas, the wedi Building Panel surface must be primed.

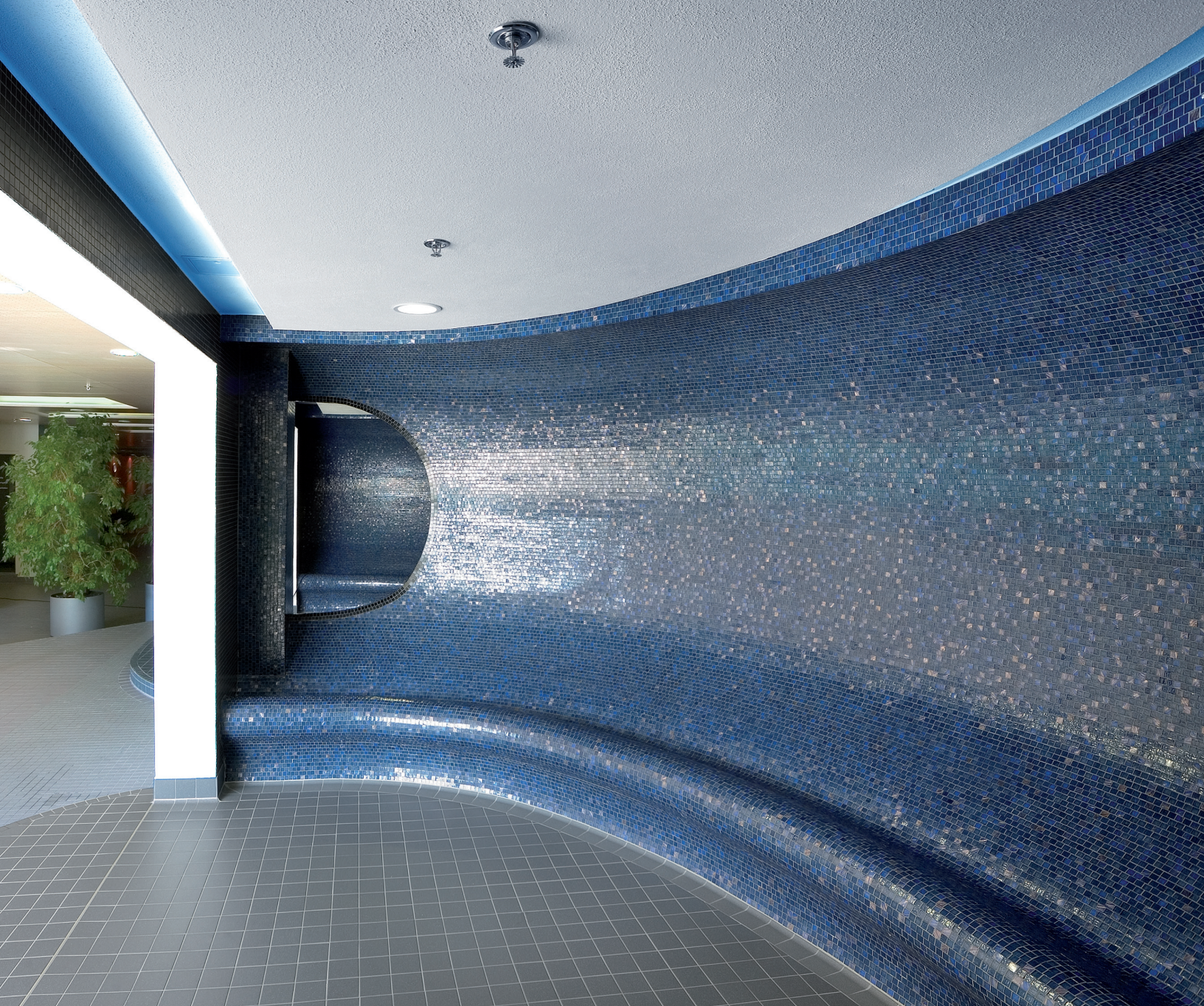

## Suspended Ceilings

The lightweight, yet extremely strong performance of the wedi Building Panel, as well as its perfectly flat surface and installation, makes it a superior backing substrate for tiles over solid or suspended, framed ceilings. Especially valuable if used in areas subject to rising water vapor such as in pool areas. When working over head, not only the lightweight handling is of great benefit. Not being permanently covered in falling dust is another nice benefit.



## Suspended Ceiling Installations

Besides wall and floor applications, the versatile wedi Building Panel can also be used for leveling and suspension of ceilings. Suspension height can be individually set during installation. For areas that require a fire barrier, additional backing material may need to be considered.

### wedi installation requirements:

- Framing must be sufficiently loadbearing and not exceed deflection of  $L/360$  in consideration of gauge, entire design of framing, material choice and total load
- stud spacing not to exceed 16" (406.4 mm) o.c.
- On metal studs we recommend to use wedi Joint Sealant to adhere the panels next to using wedi screws and tab washers. wedi's ceramic coated screws are used for wood studs and 20 ga. metal framing. For heavier ga. framing from 18 ga. and less, wedi self-tapping screws and tab washers are used



01  
Install the ceiling suspension systems to the existing ceiling by using dowels and set the desired suspension height.



02  
Install the corresponding profile onto the already installed support.

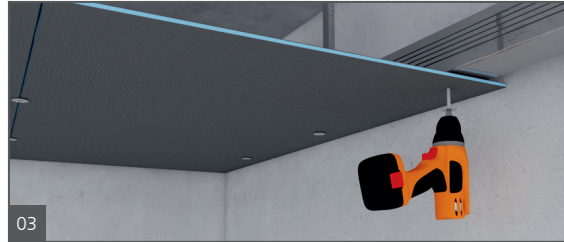

03  
Screw wedi Building Panels to framework using wedi's ceramic coated coarse thread screws and galvanized tab washers. Self tapping screws will be need when installing to metal framing 18 ga. or heavier. The fastener pattern is 1 fastener per every 6" (152.4 mm). Make sure to always use washers/fasteners in panel seams to ensure smooth transitions.

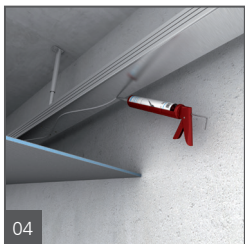

04  
When installing wedi Building Panels to metal stud ceiling framework, use wedi Joint Sealant in addition to wedi screws and Washers.

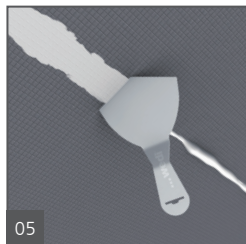

05  
Seal all joints and fastener points using wedi Joint Sealant. In dry areas, use wedi Self Adhesive Mesh Tape.